

Kitchen Sink Front Only, 34 1/2" High

End Stiles 3" Wide,

Trimmable 1 1/2" Each End

1 False Drawer Front, 1 Door

Order floor separately (SFB36 OR SFB48)

SF18	18"	3
SF21	21"	3
SF24	24"	3
SF27	27"	4

2 False Drawer Fronts, 2 Doors

SF30	30"	4
SF33	33"	4
SF36	36"	5
SF39	39"	5
SF42	42"	6
SF45	45"	6
SF48	48"	7

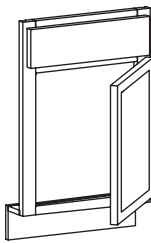

End Stiles 3" Wide,
Trimmable 1 1/2" Each End
1 False Drawer Front, 1 Door

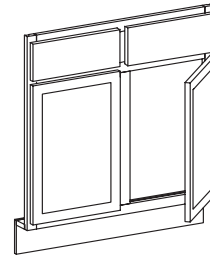

End Stiles 3" Wide,
Trimmable 1 1/2" Each End
2 False Drawer Fronts, 2 Doors

Kitchen Diagonal Corner Sink Front Only

Not Trimmable, 34 1/2" High,

Order floor separately requires
(1 VYL 1/2X4X4 for floor field trim to fit.)

1 Drawer Front, 1 Door

CASF36X36	36"	5
CASF39X39	39"	6

1 Drawer Front, 2 Paired Doors

No Center Mullion

CASF42X42	42"	6
-----------	-----	---

Order floor separately requires
(1 VYL 1/2X4X4 for floor field trim to fit)

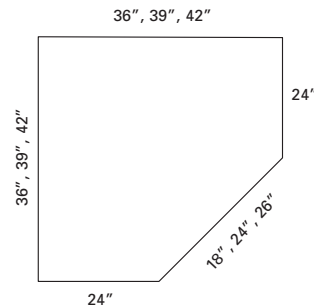
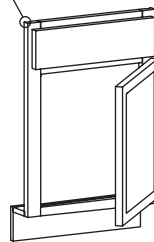
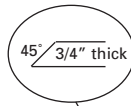

approximate dimensions

Kitchen 90° Corner Sink Front Only

Not Trimmable, 34 1/2" High

2 Full Height Doors,

Doors Hinged As Bi-fold Type.

Order floor separately requires
(1 VYL 1/2X4X4 for floor field trim to fit)

CSF36X36	36"	5
CSF39X39	39"	6
CSF42X42	42"	6

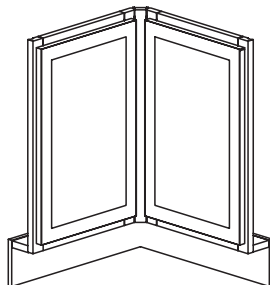

Not Trimmable

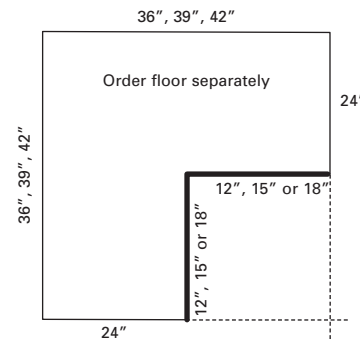

Order floor separately

Kitchen Recessed Diagonal Corner Sink Front & Floor

Not Trimmable, 34 1/2" High,

1 Drawer Front, 1 Door

DSF39X39+Floor	39"	6
----------------	-----	---

Requires 39" along two walls

DSF42X42+Floor	42"	6
----------------	-----	---

Requires 42" along two walls

Floor Panel For Sink Fronts

1/2" Particleboard one surface finished same as cabinet interior

24" X 36"		
SFB36	36"	3
24" X 48"		
SFB48	48"	3
48" X 48"		
VYL1/2X4X4	48"	4

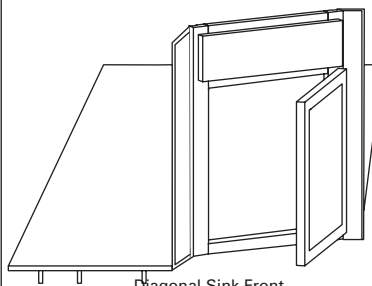

Diagonal Sink Front
Not Trimmable

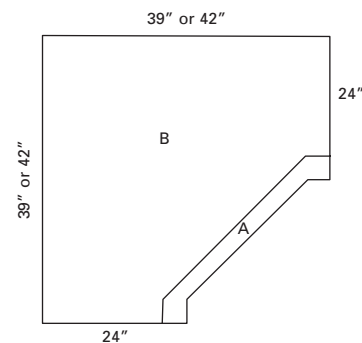

Part A, Front with toekick & part of floor attached.
Part B, Floor platform with cleat supports underneath attached.
Part A & B mated in field by cabinet installer.