

24" & 24 1/2" High, 12" Deep Peninsula Blind Corner Upper Cabinet

Double Face *F/O = 24" High*
S/O = 24 1/2" High

1 Door Front, 2 Doors Back
1 Adjustable Shelf

PBW3024	30"	7
PBW3624	36"	8

2 Doors Each Face,
1 Adjustable Shelf

PBW4224	42"	10
PBW4824	48"	11

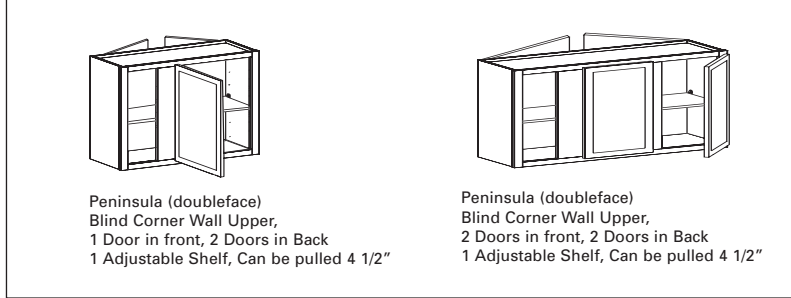

Peninsula (doubleface)
Blind Corner Wall Upper,
1 Door in front, 2 Doors in Back
1 Adjustable Shelf, Can be pulled 4 1/2"

Peninsula (doubleface)
Blind Corner Wall Upper,
2 Doors in front, 2 Doors in Back
1 Adjustable Shelf, Can be pulled 4 1/2"

30" High, 12" Deep Peninsula Blind Corner Upper Cabinet

Double Face
1 Door Front, 2 Doors Back
2 Adjustable Shelves

PBW2730	27"	8
PBW3030	30"	9
PBW3630	36"	10

2 Doors Each Face,
2 Adjustable Shelves

PBW4230	42"	12
PBW4830	48"	13

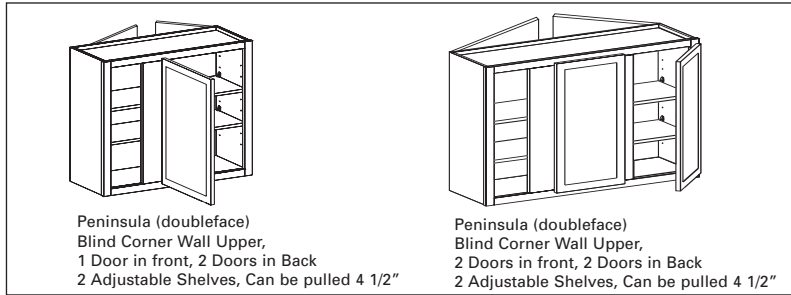

Peninsula (doubleface)
Blind Corner Wall Upper,
1 Door in front, 2 Doors in Back
2 Adjustable Shelves, Can be pulled 4 1/2"

Peninsula (doubleface)
Blind Corner Wall Upper,
2 Doors in front, 2 Doors in Back
2 Adjustable Shelves, Can be pulled 4 1/2"

36" High, 12" Deep Peninsula Blind Corner Upper Cabinet

Double Face
1 Door Front, 2 Doors Back
2 Adjustable Shelves

PBW3036	30"	10
PBW3636	36"	12

2 Doors Each Face,
2 Adjustable Shelves

PBW4236	42"	14
---------	-----	----

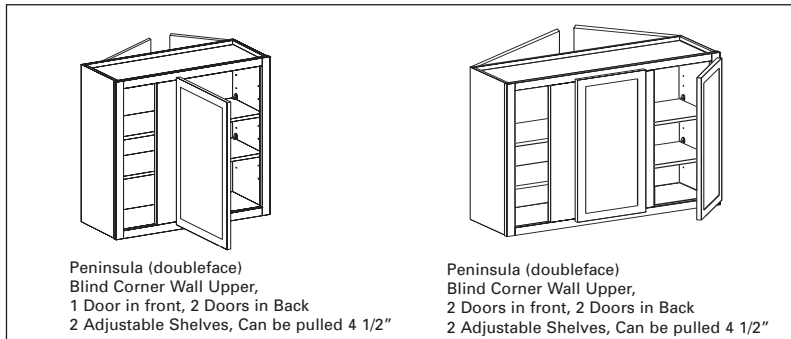

Peninsula (doubleface)
Blind Corner Wall Upper,
1 Door in front, 2 Doors in Back
2 Adjustable Shelves, Can be pulled 4 1/2"

Peninsula (doubleface)
Blind Corner Wall Upper,
2 Doors in front, 2 Doors in Back
2 Adjustable Shelves, Can be pulled 4 1/2"

42" High, 12" Deep Peninsula Blind Corner Upper Cabinet

Double Face
1 Door Front, 2 Doors Back
3 Adjustable Shelves

PBW2742	27"	11
PBW3042	30"	12
PBW3642	36"	14

2 Doors Each Face,
3 Adjustable Shelves

PBW4242	42"	16
---------	-----	----

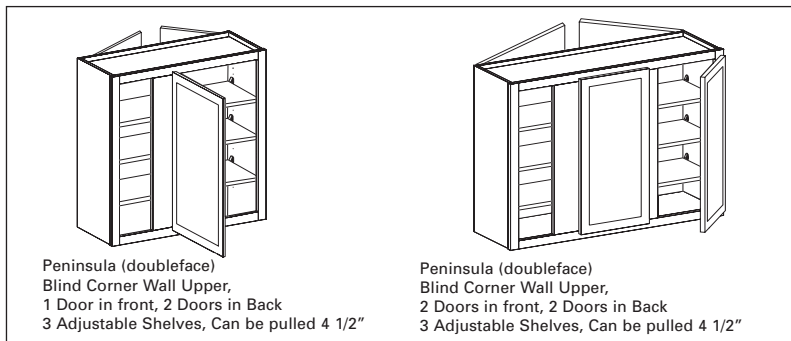

Peninsula (doubleface)
Blind Corner Wall Upper,
1 Door in front, 2 Doors in Back
3 Adjustable Shelves, Can be pulled 4 1/2"

Peninsula (doubleface)
Blind Corner Wall Upper,
2 Doors in front, 2 Doors in Back
3 Adjustable Shelves, Can be pulled 4 1/2"